

NICY Deep Cleansing Brush



User's manual

Please read this manual carefully before use



Precautions when using the body device:

1. Press the power button for more than 3 seconds to turn it on. It cannot work while charging.
2. When using the finger, hold the sensor strip around the metal surface to form a loop with the human body.
3. Use with cleansing water or cleansing lotion when exporting. Do not use it with facial cleanser/cleansing oil.

Features

Skin Rejuvenation Face Massager

this is a deep cleansing, revitalizing skin instrument, which put many functions in one, such as positive and negative ions + EMS micro current + heating + micro vibration+ Phototherapy.

Positive and negative ions: the principle of Congeniality afoul, isomerism attract-ed. The active ionic component in skin care products will accelerate and strengthen the pores and cell gaps through the skin and penetrate into the skin, which will more than double the penetration rate of skin care products. Among them, the positive ions are exported, combined with the makeup remover, the deep dirt is exported, and the skin is thoroughly cleaned; the negative ions are introduced, and the skin care products are used to penetrate the muscle base and protect the skin.

EMS micro-current: stimulating muscle and massage through micro-current, which restores muscle elasticity. At the same time, current stimulation of the dermis also promotes the production of more ATP, which is a key substance for collagen production.

Heating: Warming promotes absorption, stretches the skin texture, which make the skin becomes fuller.

Micro-vibration: using mechanical vibration and electronic stimulation to tighten the human skin, increase its elasticity and enhance the metabolism of skin cells.

Phototherapy: Blue Light repairs rough skin surface, makes skin fine and smooth, inhibits acne and eliminates acne; red light promotes collagen production and effectively inhibits skin wrinkles/darkness/stain, restores skin's elasticity and shine.

Name of each component



Product Parameters

Product Name	Deep Cleansing Brush
Models	NICY
Product Size	36*66MM
Product Net weight	95G
Including	One machine, Manual and USB line
Input voltage	DC 5V/1A
Rated power	4W
Rated voltage/Rated Capacity	3.7V/600mAH
Waterproof	IPx7
Intensity	4
Place of origin	Shenzhen
Executive standard	GB 4706.1-2005 GB 4706.15-2008

www.primy.com

hello@primy.com

Four modes of use

Press the power button to switch the mode, press the high and low buttons to adjust the current strength or vibration.

The first mode Export mode (blue light + EMS micro current + micro vibration + heating) --- Insert the cleansing cotton on the alloy surface, adjust the current with high and low button.

Second mode Cleansing mode --- Use silicone cleansing, adjust the current with high and low button.

The third mode is the import mode (red light + EMS micro current + vibration + heating) --- Put essence on the surface of the alloy, adjust the current with high and low button.

The fourth mode phototherapy mode (phototherapy + heating) --- Contact the face with the alloy surface for phototherapy.

note:

- * Use export mode first, then use cleansing mode.
- First remove the dirt from the pores to the surface of the skin, then wash it off with facial cleanser.
- * Each mode sets a 4-minute usage time.
- * After 4 minutes, the instrument will enter the standby state, and will automatically shut down after 1 minute of no action.

How to use the export mode (use with cotton pads)

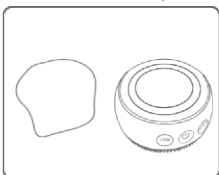

Preparing a cotton pad

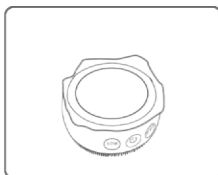

Attach a cotton pad

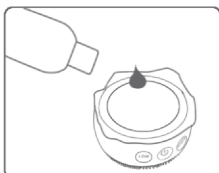

Pour the makeup remover and turn it on



Face circle cleaning

Import mode usage

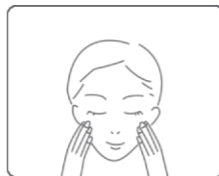

Apply a mask to the face

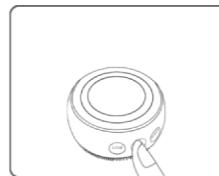

Turn on, select import mode



Hold the sensor strips on both sides of the instrument and lift the face from top to bottom



Leave the remaining mask essence clean, wash off or massage

Phototherapy mode use

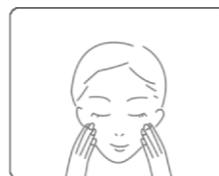

Apply toner or lotion evenly to the skin

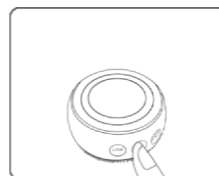

Turn on, choose phototherapy mode

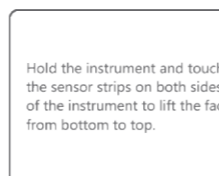

Hold the instrument and touch the sensor strips on both sides of the instrument to lift the face from bottom to top.



Recommended using method

chin

Place the massage head in the middle of the chin, toward the corner
In a curved manner, massage at a constant rate for 2 seconds.

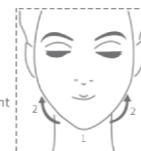

Interfacial line

Place the fuselage in the corner position and 2 to the cheekbones
The second is uniform, and the massage is lifted from the bottom up.

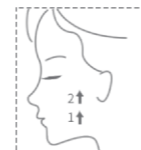

cheek

*The action of the cheek is divided into two parts: [1] and [2]

[1]

Attach the massage head to the side of the lip, to the cheekbone
Lower and upward arc-shaped technique, lifting at a constant speed of 2 seconds.



[2]

Attach the massage head to the side of the lip, in the direction of the earlobe
In a curved manner, massage at a constant rate for 2 seconds.



Safety Precautions

1. Facial plastic surgery, subcutaneous metal implantation, pregnancy should not be used.
2. The guide is wiped with a paper towel, water washing is prohibited, and metal objects are prohibited.
3. Do not put it in a damp place such as a bathroom, causing a short circuit.
4. Only care for the face and neck, avoiding acne, acne and red blood. Sensitive muscles are not recommended for daily use, can be used once a week.

Cleaning / maintenance / collection / warranty

Clean:

The cleaning machine must be kept off, rinse with warm water mixed with neutral detergent.

Maintenance:

1. If the product is damaged, do not continue to use it.
2. It is strictly forbidden to disassemble the machine by itself. If there is any malfunction or the machine cannot be used normally, please send it back to the designated after-sales service center for inspection and maintenance.

Collection:

Turn off the instrument and store it in a dry place, away from direct sunlight when you do not use it in long time.

Warranty:

We could change new one if there is quality problem within one year, but the damage caused by man-made is not within the warranty.