

BLOOM

Photon Skin Therapy Beauty Device

USER MANUAL & WARRANTY INFORMATION



www.praimy.com

hello@praimy.com



Contents

01	Introduction
02	Important
03	Important
04	Contraindications and other warnings
05	Contraindications and other warnings
06	Product Mix
07	Function Guide
08	Function Guide
09	Function Guide
10	How to charging
11	Cleaning the instrument
12	Warranty terms and conditions, Environment
13	Specifications, Disclaimer

Introduction

Thank you for purchasing your new Photon Peeler. Photon Peelers use a specific wavelength LED array to deliver concentrated near-infrared, red, blue, and orange beams to achieve phototherapy effects. These specific wavelengths of light beams provide you with a professional phototherapy facial experience that leaves you feeling soft, smooth, firm, clean, fair and radiant skin.

Do a simple aptitude test before first use
Test the device on a less sensitive area, such as the inside of your arm, before starting your facial as described in the "Function Guide". Wait 24 hours and observe the test area, if you don't notice anything unusual (redness or skin sensitivity), you can start using it.

IMPORTANT

Read this user manual carefully before you use the instrument and keep it for future reference.

Danger

- Keep the instrument dry. Never immerse it into water.
- Do not charge this instrument in wet surroundings (e.g. near a filled bath, a running shower or near a filled swimming pool).
- Never throw the instrument into fire.

Warning

- Do not use the instrument, the attachment if it is damaged or broken to avoid injuries.
- Fully charge the instrument at least every 2 months to sustain battery lifetime.
- This instrument is not intended for use by persons younger than 12 years and persons with reduced physical, sensory or mental capabilities, or lack of experience and knowledge, unless they have been given supervision or instruction concerning use of the instrument by a person responsible for their safety.
- Do not insert metal-containing material into the socket of the instrument plug to avoid short circuiting.
- Women who are pregnant or lactating are not recommended to use this instrument.

IMPORTANT

Caution

- Do not use the instrument for any other purpose than described in this manual.
- Charge, use and store the instrument at a temperature between 5°C/40°F and 35°C/95°F.
- Do not use the instrument if you are taking steroid based medication.
- Do not use this instrument if your skin is still recovering from a cosmetic procedure, such as a chemical or mechanical peeling, laser resurfacing, fractional laser treatment, or mesotherapy treatment or any other treatment with dermal fillers in the past two weeks.

General

- Regular cleaning of the instrument ensures optimal results and a longer life of the instrument.
- Do not use when sleeping or drowsy.

CONTRAINDICATIONS AND OTHER WARNINGS

- Consult your dermatologist prior to using the light therapy beauty instrument if you have medical concerns.
- Do not use the instrument for severe, nodular or cystic acne.
- Do not use the instrument on or come in contact with injured skin or skin that has undergone surgery.
- Do not use the instrument on beauty spots/moles, warts, ingrown hairs or irritated skin.
- Do not use the instrument if you are particularly sensitive to light.
- Do not use the instrument if you have had sunburn within the past 2 weeks.
- Do not use instrument in and around the eye and lip area.
- Do not apply the treatment to a spot more than 3 times daily. any more often than this could lead to skin burns or injuries. leave a minimum time of 4 hours between each treatment.
- Do not use instrument longer than 2 minutes on one blemish. overuse can lead to skin injury.
- Excessive use beyond the recommended treatment time may cause the instrument to become warm. the instrument's temperature will not go beyond 40°C if used at room temperature, but may cause discomfort or prolonged redness.
- If after using instrument you experience a worsening of the skin (skin feels tense, uncomfortable, irritated, red, burning, etc.), undesired side effects or prolonged redness, stop using the instrument and consult your doctor. however, a temporary, mild reddening after application is normal.
- Never look directly at the blue light, red light and orange light as this could lead to eye injury.

CONTRAINDICATIONS AND OTHER WARNINGS

- Children should not use or play with the light therapy beauty instrument. the light therapy beauty instrument has not been tested on children and may cause skin injury such as temporary redness or pigment changes (hypo- and hyperpigmentation) or affect their eyes.
- Proper supervision and instructions for safe use should be given to those with reduced physical and mental abilities.
- Do not share the light therapy beauty instrument with other people. sharing the instrument could transfer bacteria from one person to another.
- Do not use the instrument if it is visibly damaged, and never attempt to open or repair the instrument. doing this could result in a serious eye or skin injury or possibly fatal electric shock.
- Pregnant or breast feeding women should not use this instrument.
- Those who have had a migraine in the past two years should not use this instrument.
- Do not use over a thyroid gland as it may result in growth stimulation.
- If you are taking drugs or steroids for pain or skin conditions that cause light sensitivity, using this instrument may result in a photosensitive reaction.
- Do not use over or near a steroid injection received within the last six months. doing so may result in a photosensitive reaction.
- In order to prevent fire or serious burns, immediately turn off instrument if it begins to overheat, keep away from aerosol products.

Product Mix

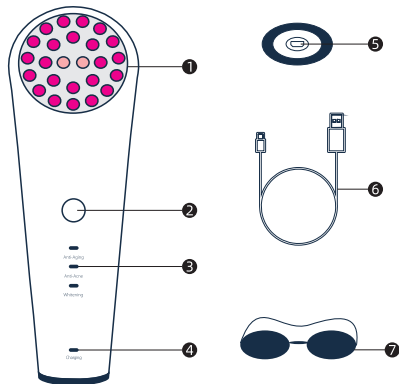

- 1 Light Head
- 2 Power on/off button
- 3 Functions Indication Light
- 4 Charging Indication Light

- 5 Charging socket
- 6 USB Line
- 7 Glasses

Function Guide

It is composed of three modes: Anti-Aging mode, Anti-Acne mode and Whitening mode, three models can be operated by a button.

***Auto Shut-off :** The instrument will automatically shut off after 10 minutes of continuous use.

Anti-Aging Mode

1.In this mode:

Near-infrared + Red light :

Near-infrared wavelengths can penetrate the human skin to a depth of 5-10MM, which is deeper than red light. With red light, multi-effect repair power, promote collagen regeneration, enhance skin elasticity, improve fine lines, and the effect of nasolabial lines is more obvious.



● Wave Length (/NM) : Near infrared - 830NM+/-3NM

● Wave Length (/NM) : Red light - 625NM+/-3NM

2.How to use

Step 1: wear the glasses first, press the power, select Anti-Aging mode.

Step 2: press as the picture, use the instrument to touch the skin and move the friction.



Function Guide

Anti-Acne Mode

1. In this mode:

Blue Light: Anti-acne cleansing, sensitive repair, balance oil, shrink pores.



● Wave Length (/NM) : Blue light - 465NM+/-3NM

2. How to use

Step 1: wear the glasses first, press the power, select Anti-Acne mode.

Step 2: press as the picture, use the instrument to touch the skin and move the friction.



000
Anti-Acne
000

1



2



3

Function Guide

Whitening Mode

1. In this mode:

Orange light: It can improve the microcirculation of the skin, fundamentally improve roughness and dullness, reduce pigmentation, and promote fairer and more radiant skin.



● Wave Length (/NM) : Orange light - 590NM+/-3NM

2. How to use

Step 1: wear the glasses first, press the power, select Soothing mode.

Step 2: press as the picture, use the instrument to touch the skin and move the friction.



000
Anti-Acne
000

1



2



3

How to charging

1. Connect the computer with the USB cable, turn on the computer, connect the USB cable to the charging socket, and connect the USB charging cable to the product USB power connection, and start charging.
2. Use the adapter to charge and connect the USB cable to the adapter.
3. The lamp shines when charged, the lamp is bright when it is full of electricity.

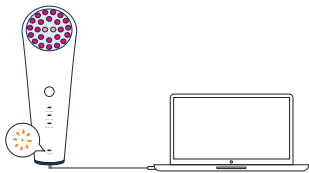

CAUTION: Before charging, make sure the charging port and charger are free from water. Do NOT use your instrument while charging, and do NOT charge for more than 24 hours. Never use the instrument if it is damaged.

Cleaning the instrument

Notes:

- Make sure the instrument is switched off before you start cleaning.
- Make sure the instrument is unplugged when you clean it. Only wipe the instrument with a dry cloth.
- Never use scouring pads, abrasive cleaning agents or aggressive liquids such as alcohol or acetone to clean the instrument.
- Clean the instrument and the probe thoroughly after each use to ensure optimum performance.
- Never rinse the whole instrument under water.
- Make sure all parts are dry before you reconnect to the adapter.

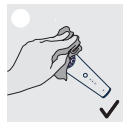
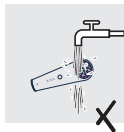

Warranty terms and conditions

1-YEAR LIMITED WARRANTY

This instrument for a period of ONE (1) YEAR after the original date of purchase, against defects due to faulty workmanship or materials. If you discover a defect and notify us during the warranty period, we will, at its discretion, maintenance the instrument free of charge.

The warranty covers working parts that affect the instrument's function. It does NOT cover purely cosmetic deterioration caused by fair wear and tear or damage caused by accident, misuse or neglect. Any attempt to open or disassemble the instrument (or its accessories) will void the warranty.

For any warranty claim, reasonable evidence must be provided that the date of the claim is within the warranty period. For this reason, please keep your original purchase receipt for the duration of the warranty period.

Environment

Do not throw away the instrument with the normal household waste at the end of its life, but hand it in and official collection point for recycling. By doing this, you help to preserve the environment.



This product must be sent to the official designated recycling center for recycling and recycling.

Specifications

MAIN MATERIALS: ABS Plastic

SIZE: 170*56*36 mm

WEIGHT: About 125 g

BATTERY: Li-ion 600 mAh 3.7 V

CHARGING: 110 min

USAGE: About 100 min

STANDBY: 60 days

INTERFACE: 1-button

Disclaimer

Users of this instrument do so at their own risk. Neither we nor its retailers assume any responsibility or liability for any injuries or damages, physical or otherwise, resulting, directly or indirectly, from the use of this instrument. Further, we reserves the right to revise this publication and to make changes from time to time in the contents thereof without obligation to notify any person of such revision or changes.

Please contact us for more comprehensive information, including user guide update, customer comments, frequently asked questions, etc.